

LIVING DISTRICT

Collection:

Installation manual for:

LDOD4020 W4.50" H16.13" E4.75" L2

Installation instructions:

1. Black wire from ceiling(junction box) attaches to "L" wire from the fixture.
2. White wire from ceiling(junction box) attaches to "N" wire from the fixture.
3. "E" wire from the fixture is attached to the mounting bracket and an additional "E" wire from the mounting bracket must be secured to the junction box.
4. Secure mounting bracket to the junction box.
5. Insert screws (P2) in the side of the mounting bracket(P1).
6. Align the holes on the side of the base(P3) and secure with the screw (P4)

The end!

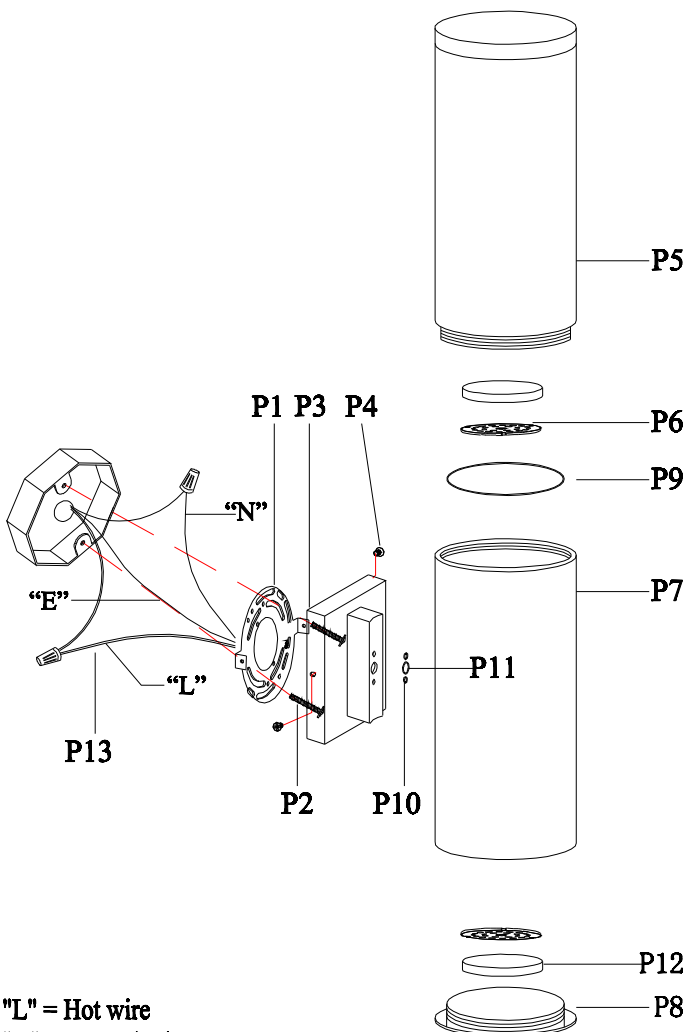

"L" = Hot wire
 "N" = Neutral wire
 "E" = Ground wire

PARTS LIST

Part	Picture	Description	Qty	Check list
P1		Mounting bracket	1	
P2		5/32-32 screw	2	
P3		Base	1	
P4		Screw	2	
P5		Fixture	1	
P6		LED 3000K	2	
P7		Aluminum pipe	1	
P8		Cover	1	
P9		Silicone rubber	2	
P10		Silicone rubber	2	
P11		Silicone rubber	1	
P12		PC Cover	1	
P13		Power wire 8" E327219 18AWG BLACK/WHITE	1	